

Command Unit

Capabilities: 1000 code capability
 Serial output to PC
 Power: 120 or 240 Vac

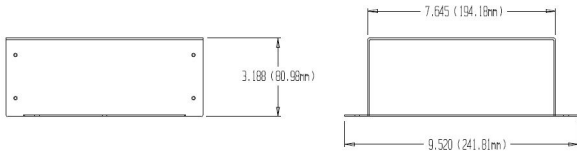

Charger

Power: 120 or 240 Vac
 Charge Time: 90 minutes
 Charges 1 to 4 sensors simultaneously

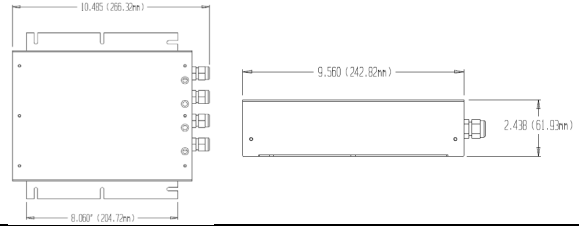

Omnidirectional Hydrophone

Beam Pattern: Omni
 Output: 100 W
 Range: 700 meters

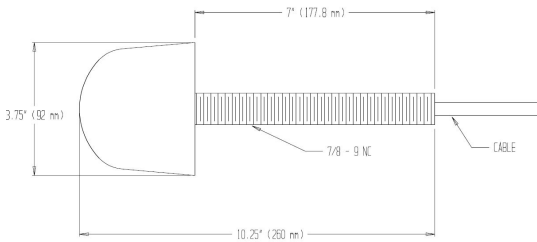

Focus Hydrophone

Beam Pattern: 70° Vertical, 70° Horizontal
 Output: 100 W
 Range: 2000 meters

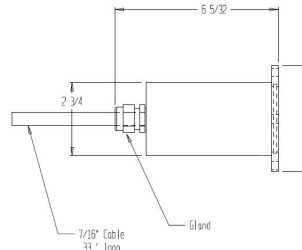

Sensors

(General specifications for all sensors unless noted)
 Range: Up to 2000 meters
 Weight: 1.1 kg in water
 Battery Capacity: Full trip capability
 Deployable Depth: 1400 m

Catch Sensor

Weight 1.96 kg in water

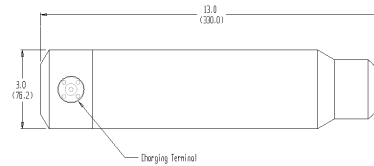

Doorspread Master, Warp Measurement Sensor

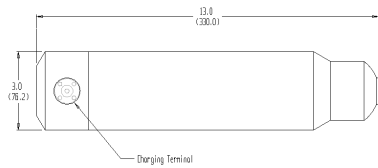

Optional Upgrades: Depth, Angle, Temperature

Warp Measurement Accuracy: +/- 0.5 meters
 Warp Measurement Resolution: +/- 0.1 meters

Doorspread Accuracy: +/- 0.5 meters
 Doorspread Resolution: +/- 0.1 meters

Optional Depth Accuracy: +/- 0.25% FS
 Optional Depth Resolution: +/- 0.1 meters
 Operating Depth: 250/500/1000/1500 meters

Optional Door Angle Accuracy: +/- 0.5°
 Optional Door Angle Resolution: +/- 0.1°

Optional Temperature Accuracy: +/- 0.5° C
 Optional Temperature Resolution: +/- 0.1° C

Warp Measurement Sensor

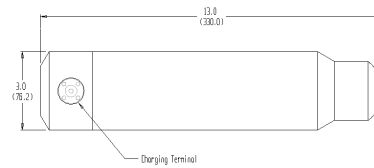

Optional Upgrades: Depth, Angle, Temperature

Warp Measurement Accuracy: +/- 0.5 meters
 Warp Measurement Resolution: +/- 0.1 meters

Optional Depth Accuracy: +/- 0.25% FS
 Optional Depth Resolution: +/- 0.1 meters
 Operating Depth: 250/500/1000/1500 meters

Optional Door Angle Accuracy: +/- 0.5°
 Optional Door Angle Resolution: +/- 0.1°

Optional Temperature Accuracy: +/- 0.5° C
 Optional Temperature Resolution: +/- 0.1° C

Doorspread Slave Sensor

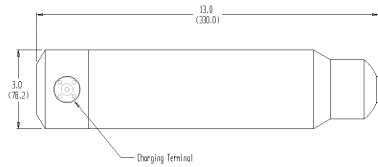

Spread Accuracy: +/- 0.5 meters
 Spread Resolution: +/- 0.1 meters

Wingend Master Sensor

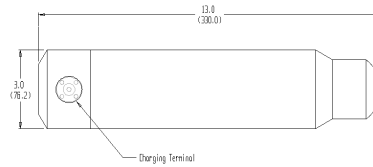

Spread Accuracy: +/- 0.5 meters
 Spread Resolution: +/- 0.1 meters

Wingend Slave Sensor

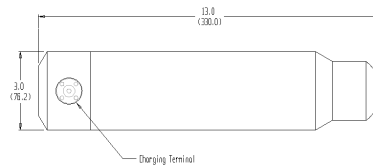

Spread Accuracy: +/- 0.5 meters
 Spread Resolution: +/- 0.1 meters

Depth Sensor

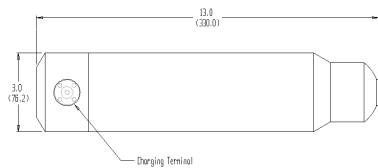

Accuracy: +/- 0.25% FS
 Depth Resolution: +/- 0.1 meters
 Operating Depth: 250/500/1000/1500 meters

Temperature Sensor

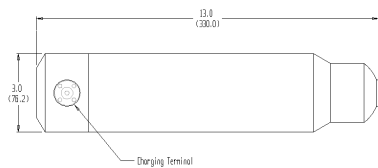

Accuracy: +/- 0.5°C
 Resolution: +/- 0.1°C

Depth Temperature Sensor

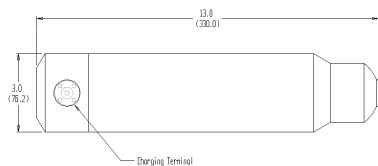

Depth Accuracy: +/- 0.25% FS
 Depth Resolution: +/- 0.1 meters
 Operating Depth: 250/500/1000/1500 meters
 Temperature Accuracy: +/- 0.5°C
 Temperature Resolution: +/- 0.1°C

Headline Height Sensor

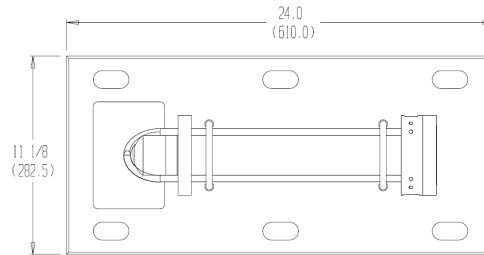

Accuracy: +/- 0.5 meters
 Resolution: +/- 0.1 meters
 Weight: 2.68 kg in water

Footline Slave Sensor

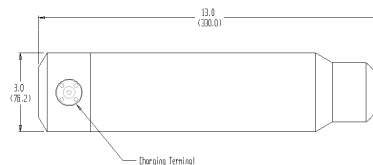

Accuracy: +/- 0.5 meters
 Resolution: +/- 0.1°

Grid Sensor

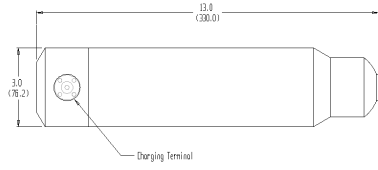

Accuracy: +/- 0.5°
Resolution: +/- 0.1°

Bottom Contact Sensor

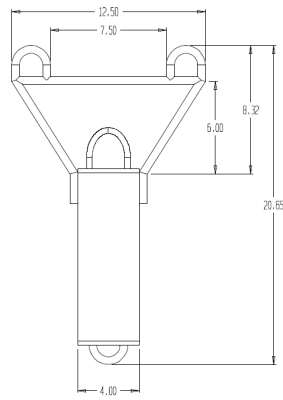

Accuracy: +/- 0.5°
Resolution: +/- 0.1°